

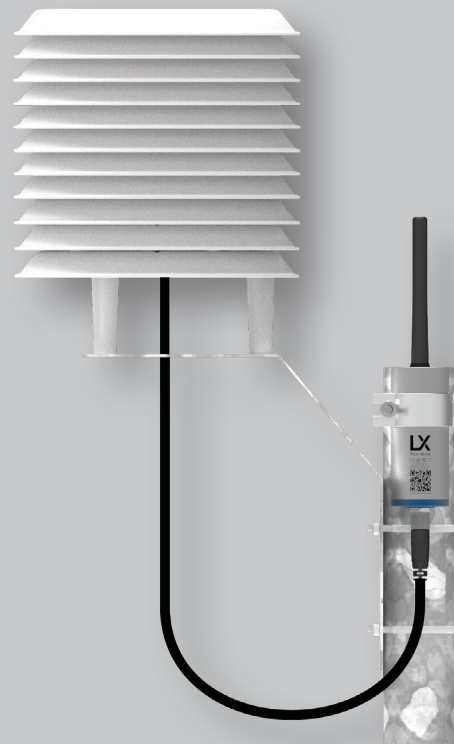

For help visit [incyt by LX](https://incyt.io/support)
incyt.io/support

Copyright 2021 LX Corporation Pty Ltd. All rights reserved.



Temperature and Humidity sensor

Quick Start Guide



Product Overview

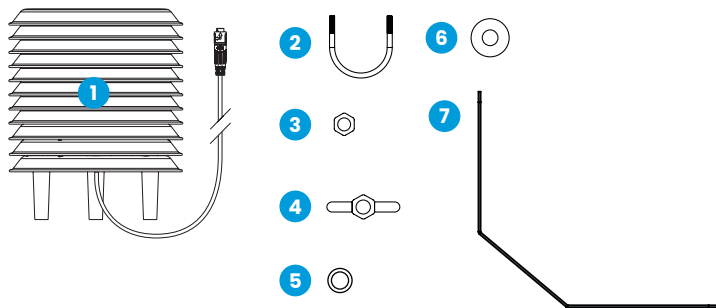

- 1 Temperature and Humidity Sensor 4 Wing Nuts X 3 7 Mounting Bracket
2 U-Bolt X 2 5 Spring washers X 4
3 Nuts X 4 6 Large Washers X 4

Preparation

- 1 Unpack the contents of the box and check the component list above to ensure that the kit is complete.
- 2 Prepare installation equipment including a set of spanners, a 32-44mm galvanised mounting pole, and the hardware required to mount or install the pole. LX strongly recommends concreting the pole into a hole at least 200mm in diameter and 600mm deep.
- 3 This Temperature and Humidity Sensor requires a LX Blue Node to function, available for purchase from [incyt.io](https://www.incyt.io). Follow the instructions provided with the Blue Node to complete setup and activation.

Installation and Mounting

- 4 Select an installation location, considering following:
 - Do not install near sources of heat or cold. This may distort readings.
 - Do not install near sprinklers or sprayers, as this will artificially increase the humidity.
 - Mount where there is a steady breeze, away from fences, buildings, trees, or other obstructions.
 - If possible, mount the sensor over vegetation or soil.
 - Installing on a hill or raised structure will significantly increase the Blue Node range.
- 5 Mount the Temperature and Humidity Sensor approximately 100mm from the top of the pole using the supplied hardware as pictured below.
- 6 Mount the Blue Node to the top of the pole, ensuring the antenna is protruding above the fixture. Plug the Temperature and Humidity Sensor connector into the Blue Node as per the Blue Node 'Quick Start Guide'.
- 7 If possible, ensure that data is correctly reporting before leaving the site.



Protect cables from animals by purchasing sheathing from your local hardware store

