

# Ultrasonic Level Sensor

Quick Start Guide

**INCYT**

## Product Overview

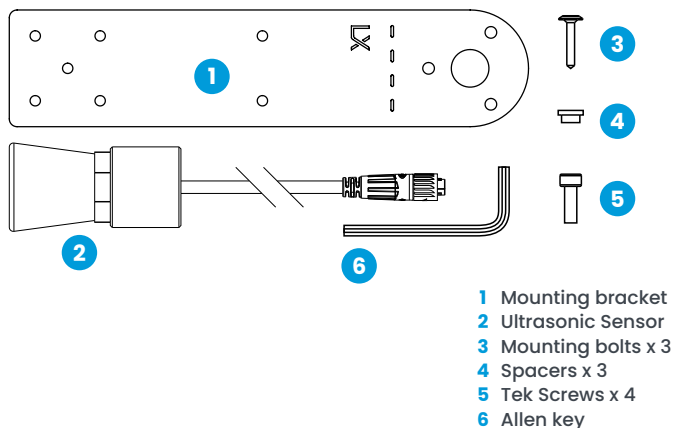

## Preparation

- 1 Unpack the contents of the box and check the component list above to ensure the kit is complete.
- 2 The Ultrasonic Sensor requires a LX Blue Node to function, available for purchase from [incyt.com.au](http://incyt.com.au). Follow the instructions provided with the Blue Node to complete setup and activation.
- 3 Ensure all components are functioning correctly before proceeding to field installation.

## Installation and Mounting

- 4 Plan your installation considering the diagrams on the right.
- 5 Once the Ultrasonic sensor and Blue Node installation is complete, ensure that data is correctly reporting before leaving the site.



Protect cables from animals by purchasing sheathing from your local hardware store

# Installation Tips

Use mounting hardware provided

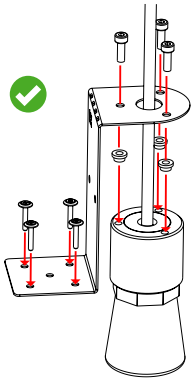

Ensure sensor is perpendicular to the water

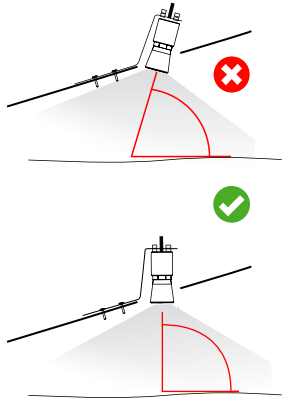

Tank

Open Water

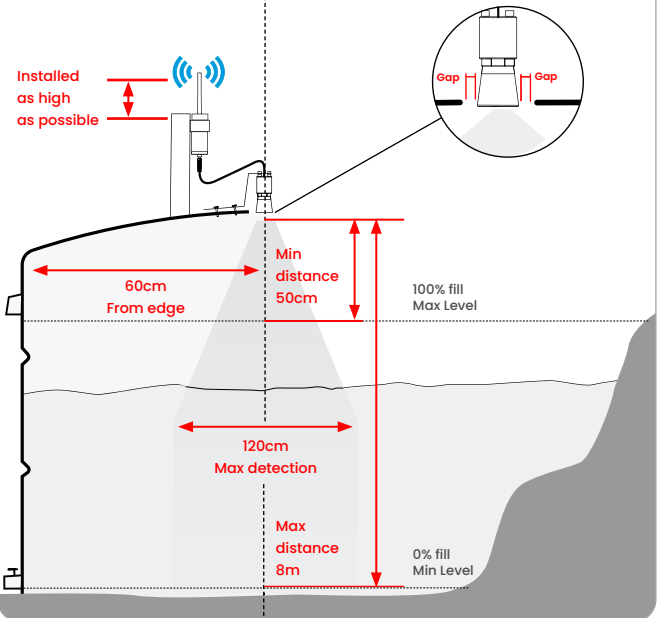

**INCYT**

For help visit INCYT  
**[incyt.com.au](http://incyt.com.au)**